

PH-2510

High Frequency Horn



Features

- 1.0" throat entry
- 100° x 80° nominal coverage
- Cut off frequency 780 Hz

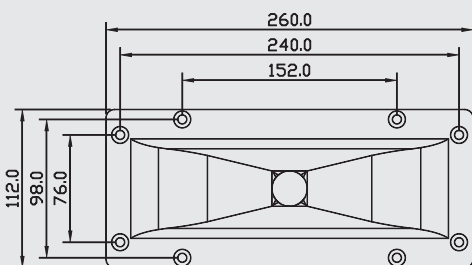

TOP VIEW

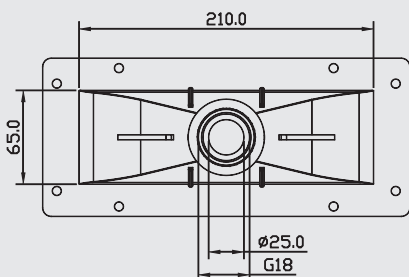

BOTTOM VIEW

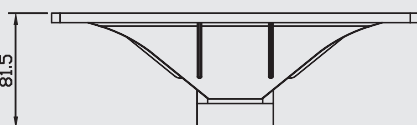

FRONT VIEW

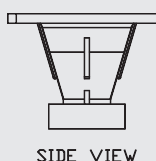

SIDE VIEW

GENERAL SPECIFICATIONS

Throat diameter	25.4 mm / 1 in
Nominal coverage angle (HxV) -6dB	100° x 80°
Cutoff frequency	780 Hz
Mounting type	Screw on
Material	Injection polymer A.B.S
Unit weight	0.26 kg / 0.57 lb
Shipping weight	0.34 kg / 0.75 lb
Packaging dimension WxDxH	275x120x100 mm 10.8x4.7x3.9 in

MOUNTING INFORMATION

Overall Dimensions

Mount Height	112 mm / 4.41 in
Mount Width	260 mm / 10.24 in
Depth	82 mm / 3.23 in

Mounting Dimensions

Rear Height	65 mm / 2.56 in
Rear Width	210 mm / 8.27 in

Baffle Cutout Dimensions

Height	75 mm / 2.95 in
Width	220 mm / 8.66 in

Frequency response and Impedance curve

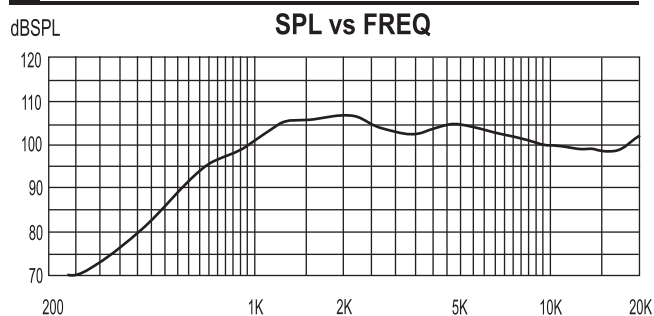

Response of horn with BM-D440S



STH PROFESSIONAL AUDIO CO.,LTD.

AIA Sathorn Tower, unit 1607-1608, 16th floor, No.11/1, South Sathorn Road, Yannawa, Sathorn, Bangkok 10120